

Snow Plow Routes

July 2024

Route 1

Take a right on Queens Road, go to 165th Ave, take a right, go to the end and turn around, go back to Queens Road, take a right, go to County Road 155 and turn around, go back to 160th Avenue, take a right, go to 360th Avenue, take a right, go to the end and turn around, go back to 160th, take a right, go to County Road 52 and tun around, go back to Queens Road, take a right, go to 165th Avenue, take a right, go to the end and turn around, go back to Queens Road, take a right, go to County Road 9, take a right, go to 363rd Street, take a right, go to the end and turn around, go to County Road 9, take a right, go to t 370th Street, take a right, go to the end and turn around, go to County Road 9, take a right, go to 175th Avenue, take a right, go to County Road 52 and turn around, go to Springwood Lane, take a right, go to County Road 9 and turn around, go to 175th Avenue, take a right, go to County Road 9, take a right, go to St Anna Drive, take a left, go to Riley Court, take a right, go to the end and turn around, go to St Anna Drive, take a right, go to 190th Avenue, take a right, go to Cardinal Nest Court, take a right, go to the end and turn around, go to 190th Avenue, take a right, go to 188th Avenue, take a right, go the end and turn around, go back to Two Rivers Road, take a right, go to County Road 9 and turn around, go to Two Rivers Road, take a right, go to North/West end of township and turn around (which is at the intersection of Two Rivers Court and Two River Road), go to Sunnyfield Circle, take a right, go around circle and back around circle to do both sides of the street, go back to Two Rivers Road, take a right, go to 190th Avenue, take a right, go to St Anna Drive, take a right, go to the end of the tar (which is at 19503) and turn around, go to 185th Avenue, take a right, go to County Road 154, take a right, go to Red Oak Circle, take a left, go to the end and turn around, go back to County Road 154, take a right, go to 188th Avenue, take a right, go to the end of the tar road (which is at 36623) and turn around, go back to County Road 154, take a right, go to 185th Avenue, take a left, go to St Anna Drive, take a right, go to County Road 9, take a right, take a right again on County Road 154, go to Sara Lane, take a left, go to the end and turn around, go back to County Road 154, take a left, go to Pelican Lake Road, take a left, go to 360th Street, turn around and go back to County Road 154, take a right, go to County Road 9, take a right, go to 360th Street, take a right, go to Tower Road, take a right, go to the end and turn around, go back to Tower Road, take a right, go to Quaker Road, take a right, go to Tomsche's place (19557) and turn around, go back to Tower Road, take a right, go to County Road 54, take a right, go to Peach Drive, take a right, go to the end and turn around, go back to County Road 54, take a left, go to Shorewood Drive, take a right, do all the roads in that part, go to the fence at the end and turn around, go back to County Road 54, take a left, go to Tower Road, take a right, go to 360th Street, take a right, go to 360th Street, take a right, go to County Road 9, take a right, go to Koppys Lane, take a right, go to the end and turn around, go back to County Road 9, take a right, go to Lower Spunk Lane, take a right, go the end and turn around, go back to County Road 9, take a left, go back to the shop, Route is done.

Route 1 Map

ROUTE 1

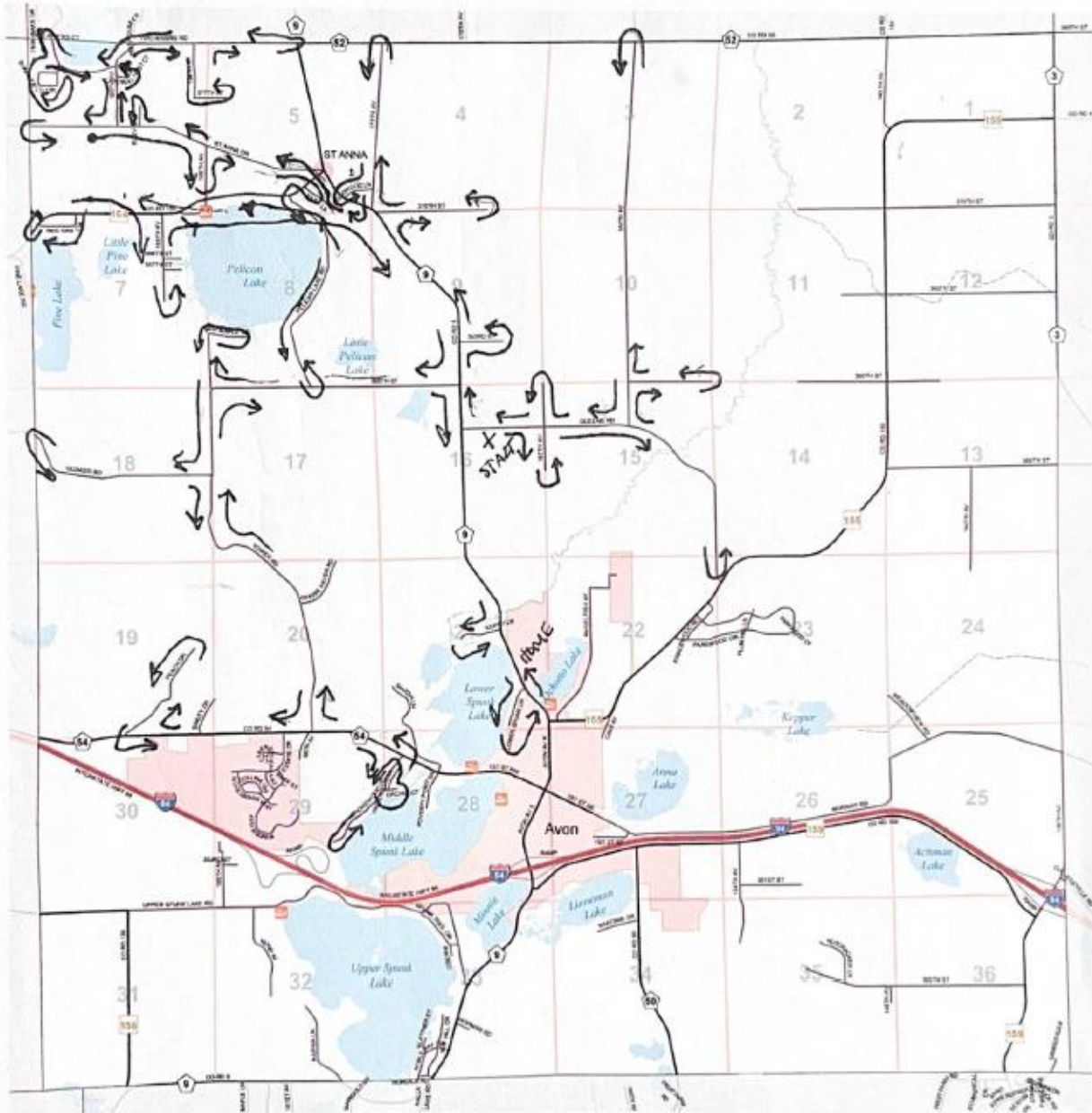

Avon Township

Route 2

Go to County Road 9, take a left, go through Avon to Upper Spunk Lake Road, take a right, go to 185th Avenue, take a right go to the dumpster and turn around, go back to Upper Spunk Lake Road, take a right, go to County Road 156 and turn around, go to 182nd Avenue, take a right, go to the end and turn around, go back to Upper Spunk Lake Road, take a right, go back to County Road 9, take a right, go to Noble Oak Circle, take a right, go to Nob Hill Drive, take a right, go to the end and turn around, go back to Noble Oak Circle, take a right, go to County Road 9, take a right, go to Narnia Lane, take a right, go to the end of the tar which is approximately 32151 and turn around, go back to County Road 9, take a left, go to Noble Oak Circle, take a left, go to Nordica Road, take a right, go to County Road 9 and turn around, go to Nob Hill Drive, take a right, go to Noble Oak Circle and turn around, go back to Nordica Road, take a right, go to Noble Oak Circle, take a right, go to County Road 9, take a left, go to Norman Road, take a right, go to cul-de-sac and turn around, go to County Road 9, take a right, go to County Road 50, will turn into County Road 159, go to 154th Avenue, take a right go to the end and turn around, go to 331st Street, take a right, go to the end and turn around, go back to 154th Avenue, take a right, go back to County Road 159, take a right, go to stop sign, take a right, go to 325th Street, take a right, go to the end and turn around, go back to County Road 159, take a left, go to the overpass and start plowing there, that is 135th Avenue, go to Norway Road, take a left, go back to Avon, turn around by city limits, go back to 1st Street SE, take a right, go to intersection of 1st Street SE and Dolphin Avenue, turn around, go back to Norway Road, go back to 135th Avenue, take a right, go back to overpass, stop plowing, take County Road 159 back to Avon, take a right on County Road 9, go to County Road 155, take a right, go to Parkwood Circle, do all the roads in there, go back to County Road 155, take a right, go to 355th Street, take a right, go to 140th Avenue, take a right, go into the farmers yard and turn around, go back to 355th Street, take a right, go to County Road 3 and turn around, go back to County Road 155, take a right, go to 360th Street, take a right, go into the farmers yard and turn around, go back to County Road 155, take a right go to 365th Street, take a right, go to County Road 3 and turn around, go back to County Road 52 and turn around, go back to County Road 155, take a right, go to 370th Street, go to the end and turn around, go back to County Road 155, take a right, go to 365th Street, take a right, go to the wood, turn around, go back to County Road 155, take a right, back to the shop. Route is done.

Route 2 Map

ROUTE 2

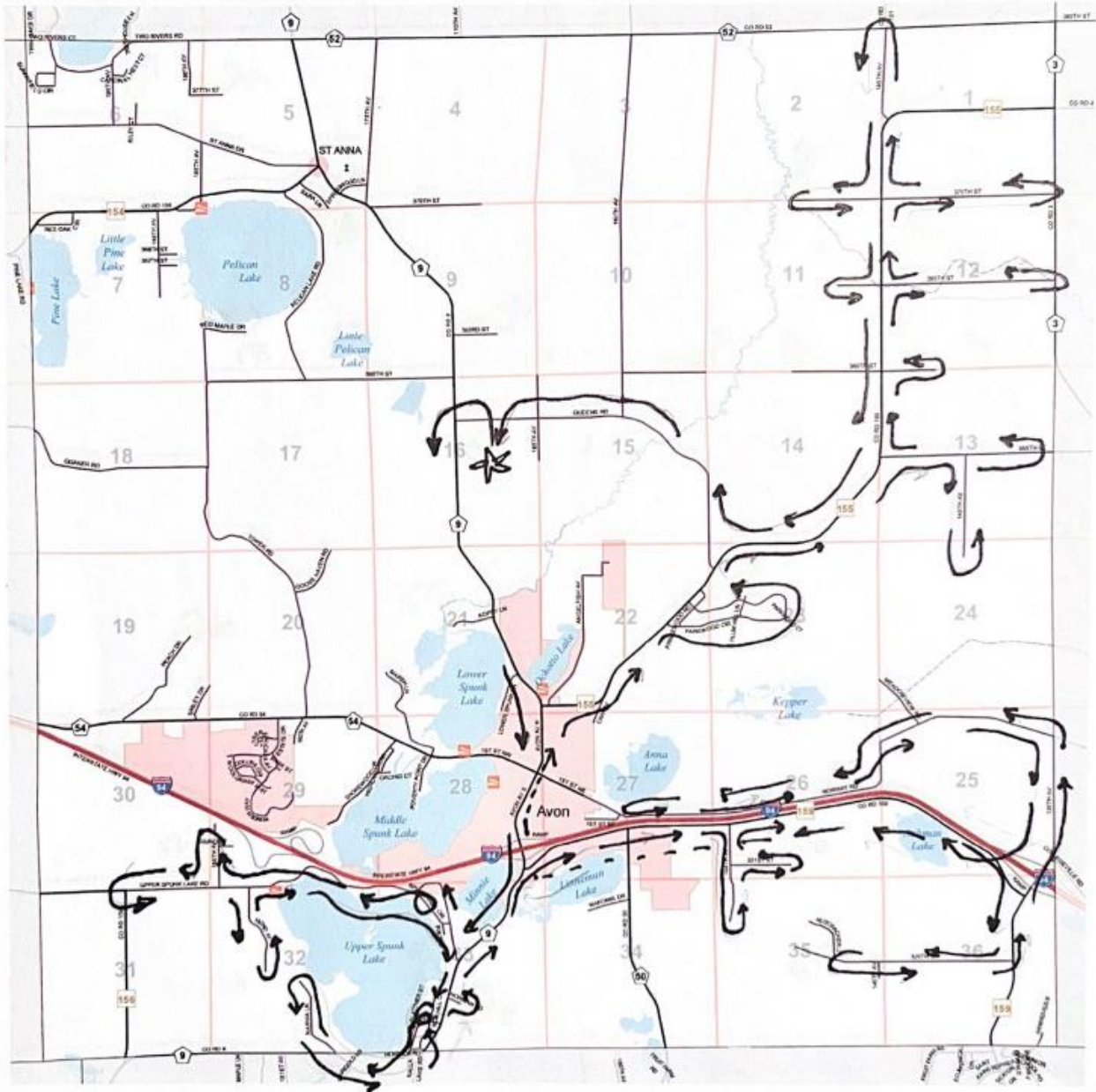

Avon Township

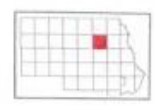

Pick-Up Route

First do the cul-de-sac at the end of 165th Ave going North, then go to 360th Street off 160th Ave. and plow the cul-de-sac at the end, then go to 360th Street off Co Rd 155, plow 360th Street going west, go past the driveway on the right about 100 feet, plow all the snow to the south, then go to 365th Street. Go west and plow cul-de-sac at the end, then go to 370th Street, go west and plow the cul-de-sac at the end, then go to Parkwood Circle and plow the cul-de-sac off of Plum Hill Lane then go to Parkwood Circle and Parkwood Court and plow that cul-de-sac. Then go to 325th street and plow the cul-de-sac at the end. Do not go down Nutcracker Lane. Then go to 154th Ave and plow the cul-de-sac at the end, then go to 331st Street and plow the cul-de-sac at the end, then go to Noble Oak Circle off of Co Rd 9, go to Nob Hill Drive and plow the cul-de-sac at the end, then go to Norman Rd and plow the cul-de-sac at the end, then go to 185th Ave by the dumpster and plow the cul-de-sac that is there, then go to 182nd Avenue and plow the cul-de-sac at the end then go to Shorewood Drive and plow the cul-de-sac that is by the fence, plow Highland Terrace, then go to Peach Drive by the big rock and plow the big spot to turn around, then go down Tower Road to the South side of Pelican Lake, take that road to the end of it, plow the spot to the south at the end of the road which is Red Maple Drive, then go to Sara Lane and plow the cul-de-sac at the end, go to Riley Court and plow cul-de-sac at the end of it, then go to 377th Street off of 186th North and plow the cul-de-sac at the end then go to 363rd Road and plow the cul-de-sac at the end, then go to Kopyy Lane and plow cul-de-sac at the end, then go to Anderson's driveway (35534 Co Rd 9) and plow her driveway, and then back to the shop.

Pick-Up Route Map

